



COLUMBIA METROPOLITAN CONVENTION CENTER





Famously hot. Surprisingly cool.

If you're looking to turn the heat up on your next event, let the Columbia Metropolitan Convention Center be your new hot spot.

Centrally located in South Carolina's historic state capital, our convention center is in the middle of an exciting urban scene that includes open-air cafés, deluxe accommodations, live music, exciting sports venues and concert tours. With our temperate seasons, Columbia offers your guests a perfect year-round business and social climate with a wide variety of world-class cultural and natural attractions. We're also only minutes away from a major airport and interstates, giving you access to anywhere you need to be.

Built in 2004, our downtown convention center is a modern and architecturally significant complex that's played host to some of the hottest special events in the Southeast. From magnificent receptions and cultural galas to corporate functions and international trade shows, our center is adaptable to the needs of most any meeting planner. The center is an impressive 142,500 square foot meeting/exhibit facility that boasts a 17,135 square foot ballroom, 15,145 square feet of meeting space and a 24,700 square foot exhibit hall.



With the capability of serving up to 2,500 guests, our state-of-the-art convention center can be divided into five meeting rooms or ten breakout rooms.

The Columbia Ballroom can be divided into three sections, making it a warm and inviting location for business lunch meetings as well as large-scale receptions. The center has also been designed to provide several pre- and post-event reception areas outside the ballroom, meeting rooms and exhibit hall. Our landscaped terrace provides the perfect site for cocktails, luncheons and conference breaks.

We also cater to your every need by serving up a wide array of delectable food and beverage options. From continental breakfasts and brunch buffets to appetizing hors d'oeuvres and multi-course gourmet dinners, our in-house catering staff has created unique and competitively priced menu options for any size event.

With full banquet facilities, a deluxe in-house kitchen and an active wine cellar, our seasoned catering professionals will give your special event a true taste of warm, southern hospitality.

From your initial inquiry, our convention center sales team will immediately begin working with you to help design flexible and personalized options for your next meeting or event. No matter what kind of meeting you're planning—wedding, corporate, political, association, fraternal or religious—regardless of size—our fiery dedication to you will help ensure your event will meet every expectation.

Convention Center Floorplans

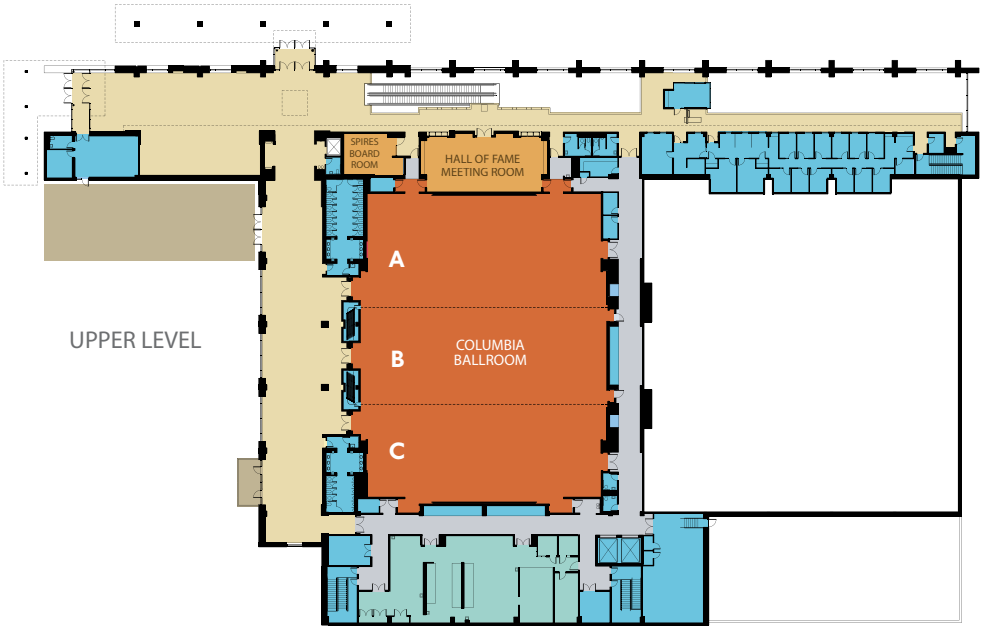

UPPER LEVEL

- | | | | | | | | |
|--|--------------|---|---------------|---|---------------|---|---------------------|
|  | EXHIBIT HALL |  | MEETING ROOMS |  | OUTDOOR SPACE |  | SERVICE |
|  | BALLROOM |  | PUBLIC SPACE |  | FOOD SERVICE |  | SERVICE CIRCULATION |



LOWER LEVEL

PARKING LOT

LOADING DOCK

The two-story facility consists of 142,500 square feet of space with the Ballroom, Board Room, Hall of Fame Meeting Room and Visitors Center located on the Upper Level. The Exhibit Hall and remainder of the meeting rooms are on the Lower Level. A terraced garden area is accessible from either level.

COLUMBIA BALLROOM	SQ FT	DIMENSIONS	THEATER	CLASSROOM	BANQUET
Combined Salons A,B,C	17,135	145' x 116'-10"	1200	850	1000
Salon A	6290	53' x 110'-10"	400	340	328
Salon B	5470	46' x 116'-10"	350	280	304
Salon C	5375	46' x 110'-10"	350	280	304
Hall of Fame Meeting Room	1540	25'-8" x 60'-6"	100	90	80
Board Room	Conference set up only—seats up to 16				

CONGAREE MEETING ROOM	SQ FT	DIMENSIONS	THEATER	CLASSROOM	BANQUET
Combined A,B	2135	59'-5" x 35'-10"	140	90	80
Division A	1080	28'-10" x 35'-10"	70	50	40
Division B	1055	28'-10" x 35'-10"	70	50	40

RICHLAND MEETING ROOM	SQ FT	DIMENSIONS	THEATER	CLASSROOM	BANQUET
Combined A,B,C	5540	90' x 61'	400	300	304
Division A	1900	30'-10" x 61'	135	100	112
Division B	1840	28'-6" x 61'	130	100	80
Division C	1800	28'-6" x 61'	125	100	80

LEXINGTON MEETING ROOM	SQ FT	DIMENSIONS	THEATER	CLASSROOM	BANQUET
Combined A,B	4045	65'-6" x 61'	280	200	192
Division A	2235	35'-6" x 61'	130	100	96
Division B	1810	28'-6" x 61'	125	100	80

CAROLINA MEETING ROOM	SQ FT	DIMENSIONS	THEATER	CLASSROOM	BANQUET
Combined A,B	1930	58' x 29'	130	90	70
Division A	950	27'-10" x 29'	60	40	32
Division B	980	28'-10" x 29'	60	40	32

EXHIBIT HALL (160' x 150')

140 Booths	24,700	10' x 10' each	1300		
------------	--------	----------------	------	--	--

1101 Lincoln Street
Columbia, SC 29201

803.545.0001
fax 803.545. 0013

1.800.264.4884
columbiaconventioncenter.com



COLUMBIA SC
FAMOUSLY HOT

**COLUMBIA METROPOLITAN
CONVENTION CENTER**